

3806/618 Lonsdale Street Melbourne VIC

1  1  1 

* Lease Term: 6 Months

* Please BOOK INSPECTIONS in advance.
Otherwise it may be cancelled unannounced.

*Please note this building has an embedded network for
one or more utility supplies.

This stunning sea-view, fully furnished apartment located in
the "Melbourne One Building" offers a modern and
spacious floorplan with high end finishes and great
locations just opposite Southern Cross Station, with
everything at your doorstep.

Type : Apartment

View : <https://www.maxion.com.au/lease/vic/inner-city/melbourne/residential/apartment/7882752>



Charlotte Chen
(03) 9989 9958

[For full version visit the website](https://www.maxion.com.au)

<https://www.maxion.com.au>

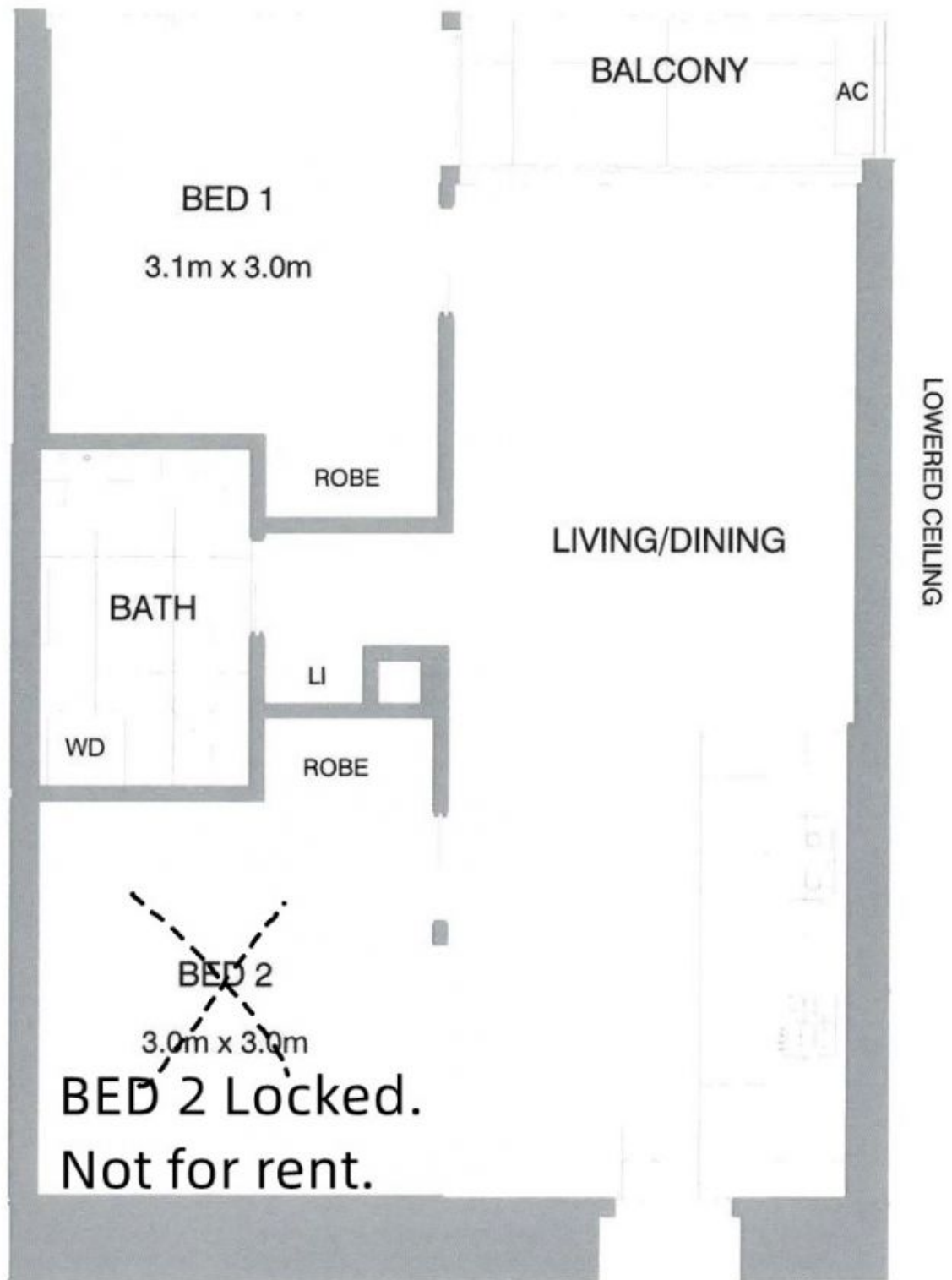

Please note current floorplan is a guide only. Interested parties must rely on their own enquiries.