



26 Brushbox Court Clayton VIC

3 1 2

- * Includes gated entrance and communal swimming pool.
- * Furniture is not included.

Spacious and modern townhouse comprises 3 bedrooms, spacious open plan living area, modern kitchen, central modern bathroom, laundry facilities, private court yard & an attractive minimum maintenance front garden.

Just minutes from the Clayton Railway Station, Monash medical centre, Monash University and Chadstone shopping centre.

Type : Townhouse

View : <https://www.maxion.com.au/lease/vic/east/clayton/residential/townhouse/7882522>

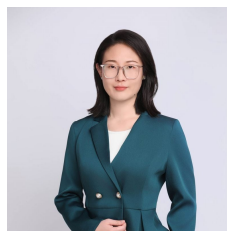

Cactus Li
(03) 9989 9958



Charlotte Chen
(03) 9989 9958

26 Brushbox Court, Clayton

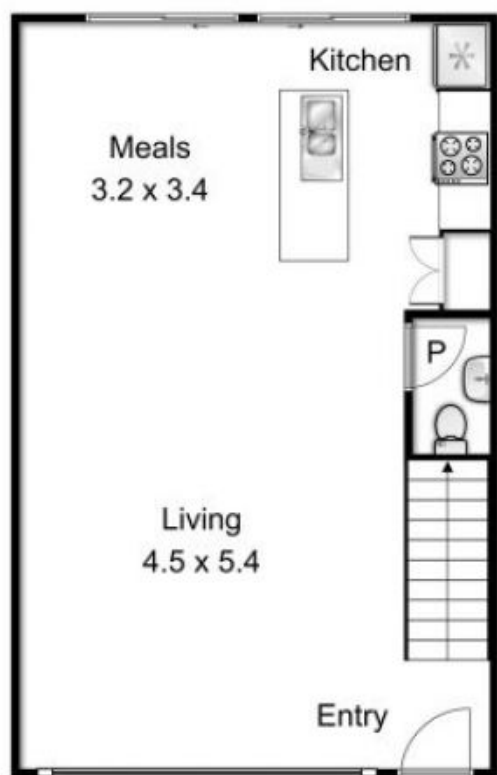
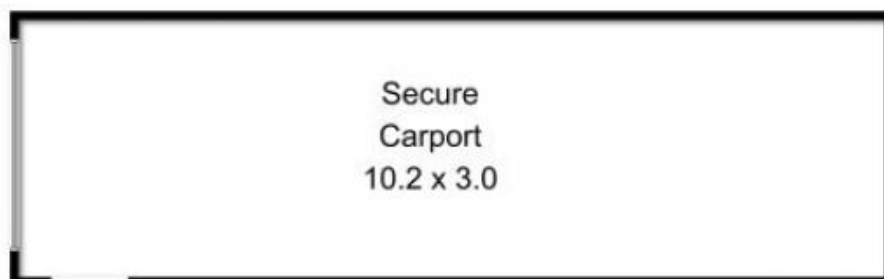

Ground Floor



First Floor



This drawing is for illustrative purposes only and while every effort has been made to maintain accuracy, prospective purchasers should check all information